

1 Ground Level  
1 : 200

2 Site Cross Section  
1 : 100

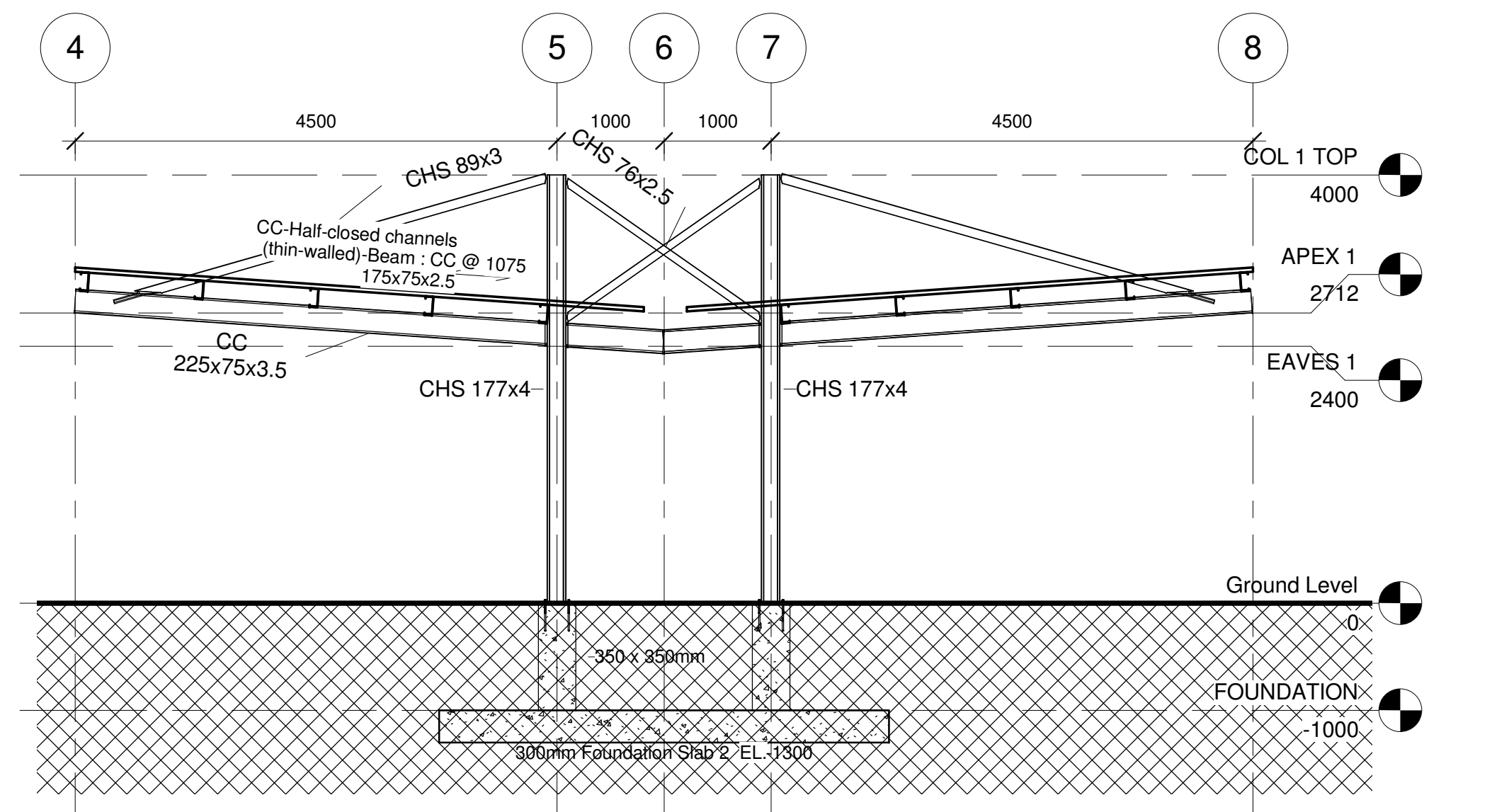

3 Double Cantilever Typical  
Section  
1 : 50

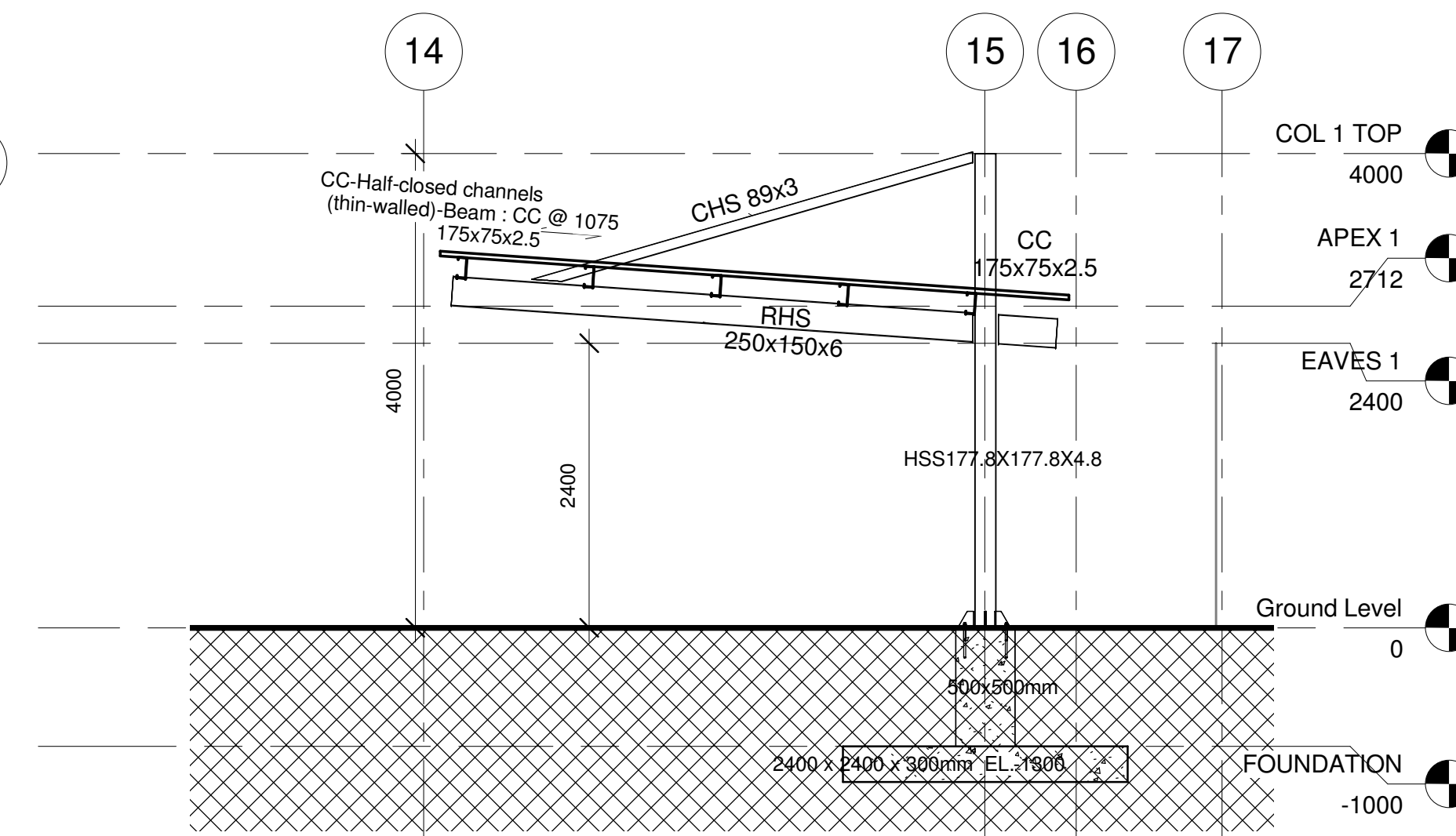

4 Single Cantilever Typical  
Section  
1 : 50

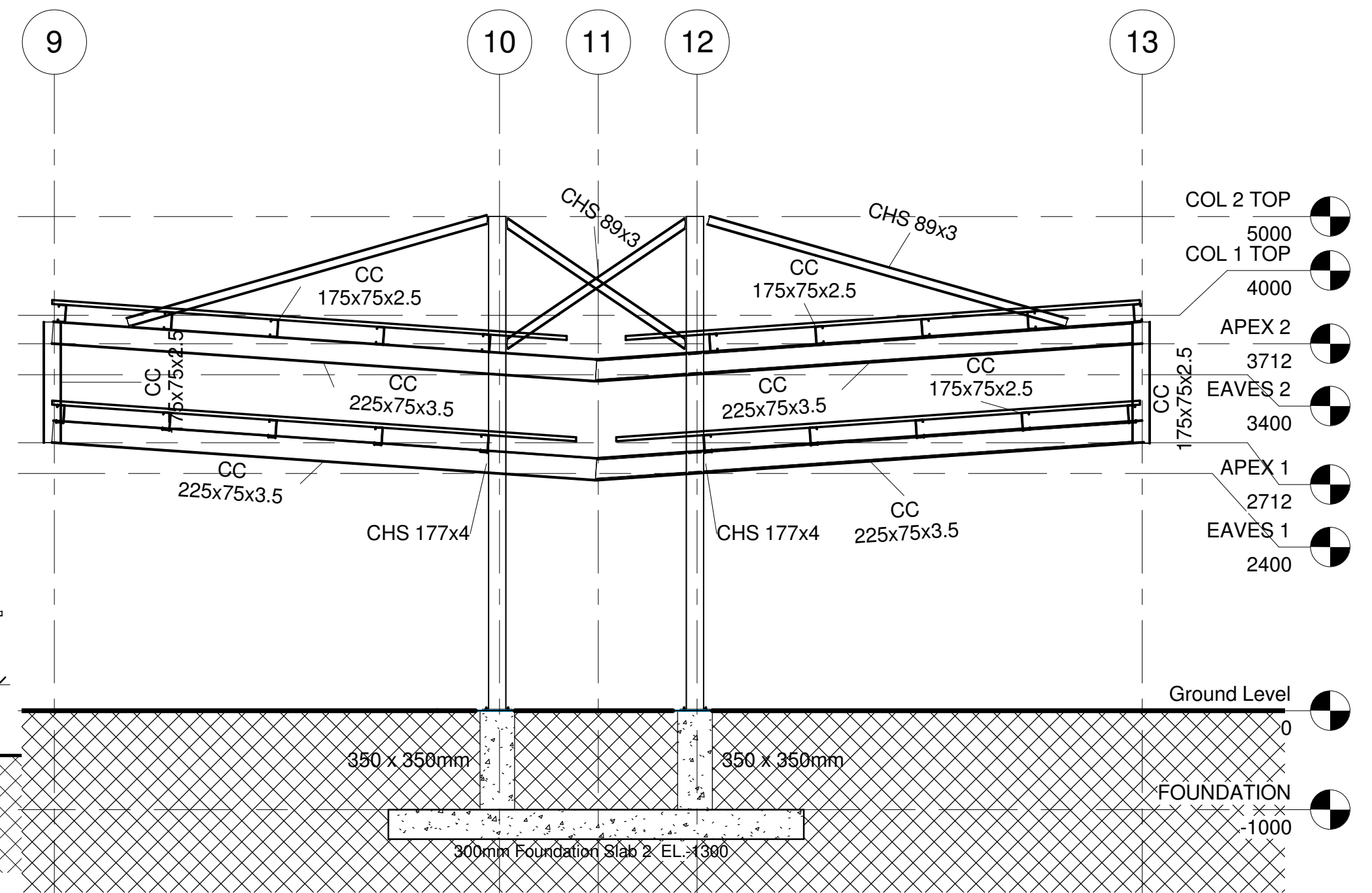

5 Section 1  
1 : 50

COPYRIGHT E-SQUARE

THIS DRAWING IS THE PROPERTY OF E-SQUARE AND SHALL NOT BE COPIED, PHOTOGRAPHED OR REPRODUCED IN ANY MANNER WHATSOEVER WITHOUT PRIOR WRITTEN PERMISSION OF E-SQUARE, NOR SHALL THE CONCEPTS CONTAINED WITHIN BE USED FOR ANY PURPOSES OTHER THAN THAT AUTHORIZED UNDER CONTRACTUAL ARRANGEMENTS WITH E-SQUARE.

#### REVISIONS

No	Date	Description	Issued by
1	3/11/2015	ISSUED FOR TENDER	TPD

APPROVED BY:

NAME

SIGNATURE DATE

CLIENT

**SARS**  
South African Revenue Service

CONSULTANT

**e-Square**  
ENGINEERING

P.O. BOX 2682  
NORTH RIDGE  
2192  
Tel: +27 (0)11 875 9907  
Fax: +27 (0)11 875 9906  
Email: info@esquareeng.com

DISCIPLINE

ARCHITECTURAL

JOB TITLE

MTHATA CAR PORTS

DRAWING TITLE

SITE LAYOUT & SECTIONS

ADDRESS/ SITE  
HILLCREST SHOPPING CENTRE, N2 NATIONAL ROAD, ERF 5703, HILLCREST, UMTHATA

DRAWN BY: TPD DESIGNED BY: TPD CHECKED BY: HHMS APPROVED BY: HHMS

DRG SCALE: As indicated DATE: APRIL 2015 PAPER SIZE: A1

REVISION No: 1

Client Project No: 1374-2014

Drawing No: 1/002