

DATE	NO	AMENDMENT
04-05-11	5	Tap mixer specification changed to eliminate clash against hydroboil and reduce cost.
06-06-11	6	Kwikot PRX-10-UB 10L under counter geyser specification and picture of typical fitment added.
25-10-11	7	Fitment of PRX-10-UB 10L made compulsory. Note clarifying electrical / plumbing requirements as shopfitters scope of works added. Litteral top colour spec changed to Tiffany.
13-06-12	8	Frankie sink changed to 1100x500 one and a half bowl. QLK 621-110 (Product Code: 820006). Cupboard Carcasses changed to industry standard sizes. 2x Side panels added.
19-08-15	12	Countertop changed to granite.
30-07-19	13	Frankie product code updates.

SCALE	As Shown (A1)
DRAWN BY	SARS
Revision Control	13.0

AMENDMENT SCHEDULE	REFERENCE DRAWINGS
--------------------	--------------------

NOTE:

- Height of Supawood Bulkhead "may" vary site to site.
- Height of 22mm Horizontal panel is always fitted as 2262 to TOP of panel from FFL.

**NOTE**

**THIS DRAWING IS A DEFAULT TEMPLATE WHICH IS REVERSIBLE LEFT TO RIGHT PER PROJECT AND INSTALLATION!**

**THE SHOPFITTER AND CONTRACTOR ARE TO MUTUALLY ENSURE THAT THE ORIENTATION OF THIS KITCHEN UNIT IS CONFIRMED ON THE ARCHITECTURAL DRAWINGS BEFORE ANY MANUFACTURE/INSTALLATION COMMENCES.**

**FAILURE TO DO SO WILL RESULT IN THE WORK BEING RE-DONE/CORRECTED BY SHOPFITTER AT NO COST TO SARS.**

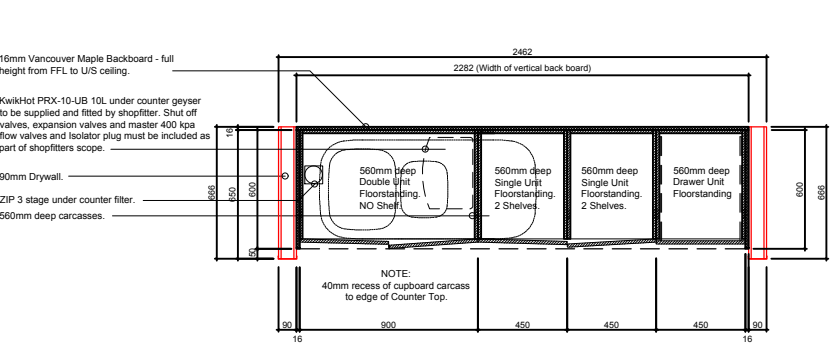
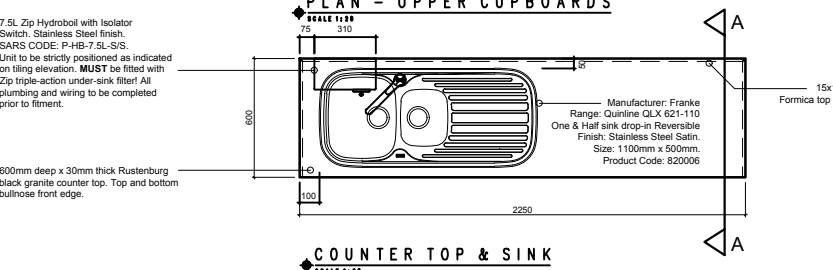
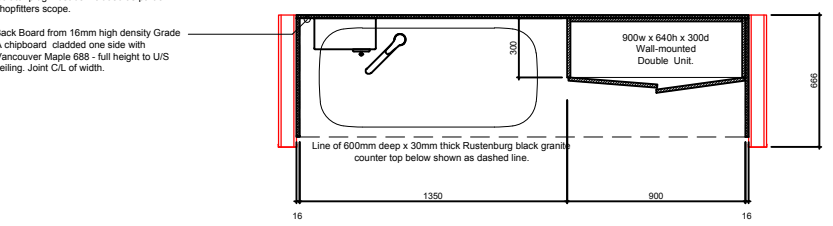
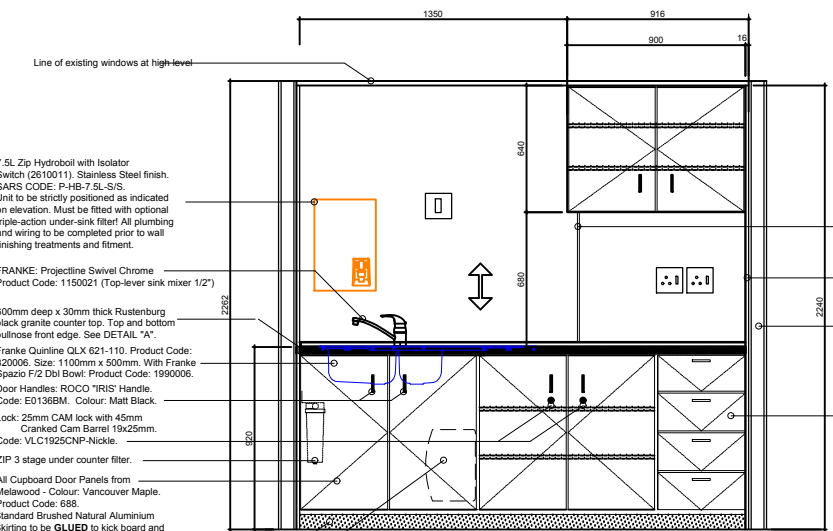
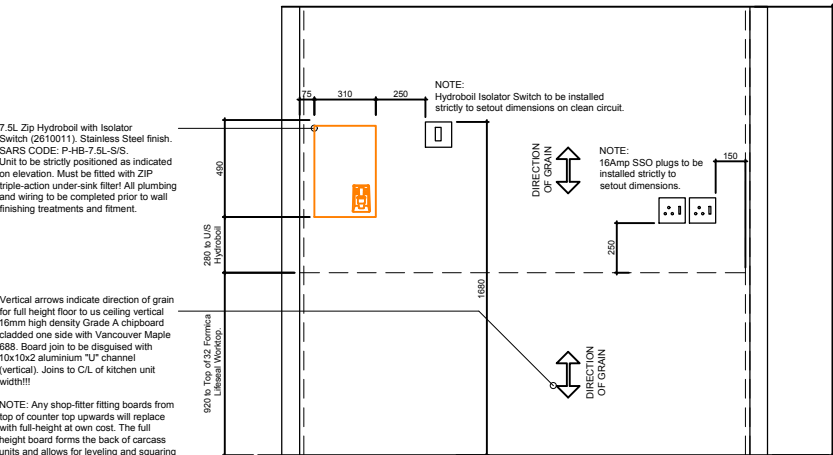
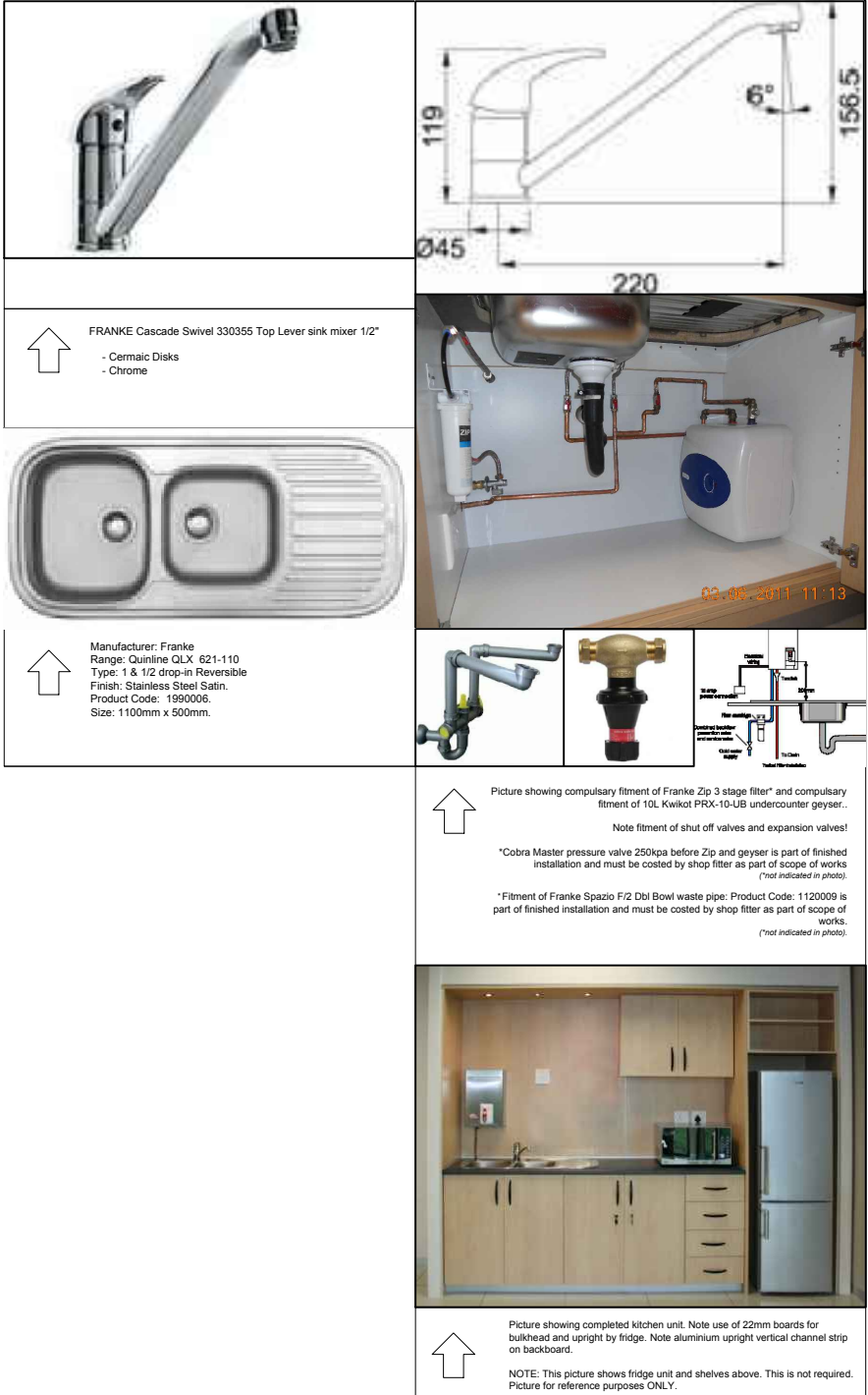

NOTE:

- All Cupboard Panels from Grade A Melawood
- Colour: Vancouver Maple. Product Code: 688.
- Grain is always vertical.

NOTE:

- ZIP HydroBoil 7.5i installation is part of the Shopfitting Specifications and full installation of the Hydroboil - including Electrical wiring, Isolator switch, plumbing and Zip 3 stage filter under sink is to be proc on by the Shop fitter as part of the shopfitting installation.
- The position of the Hydroboil installation is critical and must be installed as dimensioned and at the correct height. The Hydroboil Tap must drip to just off C/L of large sink bowl and must not under any circumstances be fitted to drip over the Franke: Cascade Swivel Chrome mixer tap below.
- Fitment of the 10L Kwikhot PRX-10-UB under counter geyser is compulsory and forms part of the Shopfitters scope of works. Fitment to include all shut-off valves, master flow pressure valves and drip-trays.
- Fitment of all sinks, tap fitting, piping, lagging, plumbing, etc forms part of the shopfitters scope of works and the shopfitter is to ensure all trades (electrical/plumbing/sewer/etc) are costed for under their pricing for this specification document.

NOTE:

- All Cupboard Panels from Grade A Melawood
- Colour: Vancouver Maple. Product Code: 688.
- Grain is always vertical.

